



*Colonial
Williamsburg*



NAHAD

24th Annual
Meeting
& Convention

*Build Bigger Value for
Your New Markets*

★ ★ ★

COLONIAL WILLIAMSBURG, VIRGINIA - APRIL 5 - 9, 2008

Program Schedule

Friday, April 4, 2008

- 11:00 am – 1:30 pm Standards Committee Meeting with Lunch
- 11:00 am – 5:00 pm Convention Registration for Early Arrivals
- 2:00 pm – 5:00 pm Board Meeting
- 5:30 pm – 6:15 pm Evening Walking Tour*

Saturday, April 5, 2008

- 7:30 am – 9:00 am Listed Subcommittee and Audit Task Force Breakfast Meeting
- 7:30 am – 10:30 am Round Robin Tennis Tournament*
- 9:00 am – 6:30 pm Convention Registration Open
- 9:00 am – 10:30 am Board and Past President Wives Breakfast
- 9:00 am – 11:30 am **NAHAD's Hose Assembly Guidelines – Focus on Training, Quality and Marketing the Value to Customers**
- 9:00 am – 5:00 pm ServiceMart and NAHAD Education Pavilion
- 9:30 am – 10:30 am Orientation Walking Tour I*
- 12:45 pm – 1:15 pm Colonial Muster and Drill
- 1:30 pm **2008 Annual Meeting and Convention Official Opening**
- 1:45 pm – 3:00 pm General Session
Build it Bigger – Extreme Engineering
Danny Forster
- 2:30 pm – 4:00 pm 18th Century Games for Children*
- 3:00 pm – 4:30 pm Afternoon Tea at the Williamsburg Inn*
- 3:00 pm – 3:30 pm Refreshment and Networking Break
- 3:30 pm – 5:00 pm General Session
Strategic Sweet Spots for Market Success
Bill McCleave
- 6:00 pm – 6:30 pm First Timers Reception
- 6:30 pm – 7:30 pm Welcome Cocktail Reception
- 7:30 pm – 10:30 pm Networking Dinner and Entertainment
The Capitol Steps

Sunday, April 6, 2008

- 7:30 am – 5:00 pm Convention Registration Open
- 7:30 am – 5:00 pm ServiceMart and NAHAD Education Pavilion
- 7:30 am – 8:30 am Tenth Annual Fun Run/Walk*
- 8:30 am – 10:30 am Golf Clinic*
- 9:30 am – 10:30 am Orientation Walking Tour II*
- 11:15 am – 1:30 pm Historic Area Tour for Children with Lunch*
- 11:30 am – 1:30 pm Spouse Lunch
- 11:30 am – 12:30 pm NAHAD Members' Lunch
- 12:30 pm – 1:45 pm Luncheon Speaker
Ultimate Performance
Gary Jobson

- 1:45 pm – 2:00 pm Networking Break
- 2:00 pm – 3:20 pm General Session
Build Your Online Marketing Machine
Bob DeStefano
- 2:30 pm – 5:00 pm Golf and Refreshment for Ladies*
- 3:20 pm – 3:30 pm Refreshment and Networking Break
- 3:30 pm – 4:45 pm General Session
Sustaining Growth through Distribution Excellence
Kathy Newton
- 6:30 pm – 11:00 pm Manufacturer Hospitality Evening

Monday, April 7, 2008

- 7:00 am – 1:00 pm Convention Registration Desk Open
- 7:00 am – 12:00 pm NAHAD Education Pavilion
- 7:00 am – 8:00 am Continental Breakfast
- 8:00 am – 8:45 am Annual Meeting of Members
- 8:45 am – 10:15 am General Session
Building a Value-Added Sales Culture
Tom Reilly
- 10:15 am – 10:30 am Coffee Break
- 10:30 am – 12:00 pm General Session
Building Customer Loyalty through Service
Christine Corelli
- 12:30 pm – 3:30 pm Williamsburg Winery Luncheon, Tour and Tasting*
- 12:30 pm – 4:30 pm Jamestown Guided Tour*
- 1:00 pm – 5:45 pm Musket Start Golf Tournament on the Gold and Green Golf Courses*
- 1:30 pm – 4:30 pm Yorktown Guided Tour*
- 1:30 pm – 3:30 pm Work and Enterprise in Colonial Williamsburg I*
- 8:00 pm – 9:00 pm Ghost Tavern Tour*
- Open Evening

Tuesday, April 8, 2008

- 6:30 am – 1:30 pm Convention Registration Desk Open
- 6:30 am – 8:00 am Exhibitor Breakfast
- 7:30 am – 8:30 am Continental Breakfast for Non-Exhibitors
- 8:30 am – 1:30 pm Contact Table Program
- 9:00 am – 3:30 pm Spouse Plantation Tours and Luncheon*
- 12:30 pm – 1:30 pm Luncheon in Exhibits
- 2:00 pm – 4:00 pm Second Board Meeting
- 2:00 pm – 4:00 pm Work and Enterprise in Colonial Williamsburg II*
- 5:00 pm – 5:45 pm First Seating Cocktail Reception
- 5:45 pm – 7:30 pm Colonial Tavern Dinner First Seating*
- 6:45 pm – 7:30 pm Second Seating Cocktail Reception
- 7:45 pm – 9:30 pm Colonial Tavern Dinner Second Seating*
- 8:00 pm – 10:30 pm After-Dinner Cocktails on the Lawn

Wednesday, April 9, 2008

Departures

* Requires Pre-registration

“That the Future May Learn from the Past”

John D. Rockefeller Jr.,
a founder of Colonial
Williamsburg

Dear NAHAD Member,

Leslie and I are eagerly looking forward to greeting you in Colonial Williamsburg, Virginia. In the summer of 2005 when we were researching sites for NAHAD's 24th Annual Meeting & Convention, we determined that Williamsburg had all the elements to make a great convention. Within easy driving distance or a short flight for many NAHAD members, the Tidewater area of Virginia has a natural beauty. Colonial Williamsburg recreates a time in history when our country was transformed from a colony of England into a new nation, the United States. The costumes, the buildings and the setting all evoke America's colonial past; but somehow the re-enactors and historical programs engage the visitor to examine one's life, leisure and work to see what matters today, and what is important to bring into the future.



We have planned a dynamic convention program with several changes that we hope will provide new catalysts for personal and business networking. Our program will kick into full gear on Saturday, April 5, when Danny Forster, host of the Discovery Channel's television show, “*Build It Bigger*”, will deliver the keynote address and set the tone for the meeting and our theme **Building Bigger Value for Your New Markets**. In our business lives, all of us have encountered changing markets – new accounts, new suppliers, profit centers that have evaporated and new markets that have emerged as profitable. As market forces interact with our businesses, it is vital to focus on those core values from the past that have built our businesses, while adapting to current market forces and building sustainability for the future.

Our line up of speakers will assist with this task. Industry experts, Bill McCleave and Kathy Newton, will look at our distribution businesses with an eye to evaluating markets and focusing products and resources to drive success. Bob DeStefano will show us some new ideas to bring our products to market – timely, targeted and efficient – through electronic marketing. On Sunday, our luncheon speaker, Gary Jobson, world class sailor, author and ESPN commentator, will motivate and inspire us with lessons learned from the world of competitive sailing. This is a presentation not to be missed; finding the resiliency and passion within to pursue excellence is important to all of us in today's competitive marketplace. Then, on Monday, we shift into areas that are important to all of our businesses, sales and customer service. Our dynamic sales presentation from Tom Reilly will focus on the value-adds that our customers demand. Christine Corelli will give us a glimpse of our customer of the future, what they will expect and demand and how we can meet their challenges.

Take a look at the Program Schedule, with the changes that you have suggested on NAHAD surveys – the Networking Dinner on Saturday night, two eighteen-hole golf courses on property will allow a complete Tournament on Monday afternoon, a five-hour Contact Table Program on

Welcome to Williamsburg

PAGE TRIMMED ON DIAGONAL

Tuesday, and our final night will be a delightful evening in a colonial tavern, with a choice of early or late seating for those with early morning flights or those who can sleep in for a later departure. Registration for this year's meeting comes with a full-stay Colonial Williamsburg Visitor's Pass, so that you can visit the exhibit buildings and museums of Colonial Williamsburg on your own timetable during the open time built into the schedule.

As a person who loves history, I enjoy every moment of my time in a place where I can get a glimpse into the past. The cabinet maker, printers and blacksmiths of the past remind me of the importance of hard work and discipline. The historical figures, like Thomas Jefferson and Patrick Henry, bring alive the beliefs that shaped a new nation with the courage of their convictions. Leslie invites you to enjoy the beautiful gardens – she has adapted several ideas to suit our home in Michigan. She has also planned a special Ladies Golf Clinic for those wanting to experience the game or to renew old skills.

Please mark your calendars and begin making plans to attend NAHAD's 24th Annual Meeting and Convention – arrive Friday, April 4 and depart on April 9, so that you can take advantage of all that this program has to offer to you! There are many lessons that can be learned from the past. I am certain that you will be engaged and energized by our 2008 Annual Meeting site. I will end with a quote from Albert D. Einstein. “Learn from yesterday, live for today, hope for tomorrow. The important thing is not to stop questioning.”

Sincerely,

Joe and Leslie Lark

Joe and Leslie Lark



PAGE TRIMMED ON DIAGONAL

Program Highlights

ServiceMart Exhibits

Saturday, April 5, 2008

9:00 am – 5:00 pm

Sunday, April 6, 2008

7:30 am – 5:00 pm

NAHAD's Affiliate Members will provide displays of their latest products and services at the 2008 ServiceMart. Affiliate members offer a range of services of particular interest to distributors and manufactures including distribution software, financial services, catalogs, insurance services, printing services, and specific products designed for the hose industry. Please include a visit to the ServiceMart when you stop at the adjacent NAHAD Registration Desk.

NAHAD's Education Pavilion

Saturday, April 5, 2008

9:00 am – 5:00 pm

Sunday, April 6, 2008

7:30 am – 5:00 pm

Monday, April 7, 2008

7:00 am – 12:00 pm

Take a moment to review NAHAD's program services designed to make your business more effective and efficient. Training materials, web-based programs, and NAHAD's Hose Assembly Guidelines will all be available for your review and consideration.

NAHAD's Hose Assembly Guidelines

Saturday, April 5, 2008

9:00 am – 11:30 am

After a brief update on the latest enhancements to the Hose Assembly Guidelines Program, you will learn how to use the program as an integral part of your company's training for employees, see how quality and safety is enhanced through participation in NAHAD's Listed program and learn the best ways to market your value to customers. Whether you are new to the Program or you have been involved since its inception, you will find this Saturday morning well spent.

First Time Attendees' Welcome and Orientation

Saturday, April 5, 2008

6:00 pm – 6:30 pm

As a first time attendee, we'd like to extend a special welcome to you. We ask you to gather together before the opening reception to meet NAHAD's leadership to receive a brief orientation as to what to expect over the next few days and how to get the most out of your attendance.

Members Opening Reception and Networking Dinner

Saturday, April 5, 2008

6:30 pm – 10:30 pm

New for 2008! NAHAD has decided to take advantage of having most of our attendees and spouses assembled to provide a cocktail reception, gala dinner and outstanding entertainment in one evening. We will begin with cocktails – on the lawn, if weather permits. Then, you will be escorted into dinner. Those who wish to catch up with old friends may do so, by choosing to sit together. If you would like to meet some new friends, we will have an opportunity to pick a table assignment from a basket for a new networking experience.

Member Conference Registration and Hospitality

Friday, April 4, 2008

11:00 am – 5:00 pm

Saturday, April 5, 2008

9:00 am – 6:30 pm

Sunday, April 6, 2008

7:30 am – 5:00 pm

Enjoy leisurely conference registration at any time convenient to you. For those arriving early in Williamsburg, we will open on Friday to give you an opportunity to pick up your registration materials and the **Colonial Williamsburg Historic Areas Conference Pass (which is included in your conference registration fee) at your leisure.** Beverages and light refreshments will be served in a relaxing setting. Then, from Saturday through Monday, use this opportunity to visit the sun-filled Virginia Foyer to browse the displays of the NAHAD Education Pavilion and member services, visit the Affiliate member ServiceMart exhibits, enjoy quiet chat with NAHAD acquaintances, and network to make new friends.

NAHAD conference registration staff will be available throughout the convention to answer questions and to assist you. Please refer to the Program Schedule for specific times.

Following dinner, you will be entertained by The Capitol Steps. The ensemble began as a group of Senate staffers who set out to satirize the very people and places that employed them. In the years that followed, many of the Steps ignored the conventional wisdom ("Don't quit your day job!"), and although not all of the current members of the Steps are former Capitol Hill staffers, taken together, the performers have worked in a total of eighteen Congressional offices and represent 62 years of collective House and Senate staff experience.

Since they began, the Capitol Steps have recorded 27 albums, including their latest, *Springtime for Liberals*. They've been featured on NBC, CBS, ABC, and PBS and now, NAHAD!

Manufacturer and Associate Sponsored Hospitality Suites Sunday, April 6, 2008 Beginning at 6:30 pm

Manufacturers and Associates are invited to entertain NAHAD's distributor members on this evening. Suites and function rooms may be reserved by contacting Stephanie Lally, NAHAD's Convention Services Manager for the Resorts at Colonial Williamsburg at 1-757-220-7457 or by email slally@cwf.org. As a special convenience, Manufacturers and Associates may order a complete set of NAHAD distributor mailing labels (no cost) or specialized reports (fee charged) from the NAHAD office. Please call the NAHAD office directly for details.

Spouse Brunch Program Sunday, April 6, 2008 11:30 am – 1:30 pm

Colonial Williamsburg has become famous for gracious and elegant entertaining. Southern hospitality makes entertaining and being entertained a true experience. NAHAD's spouses will learn a bit about the art of making a meal memorable from Chef Rhys Lewis. Enjoy a relaxing Sunday afternoon, with three delicious courses, each paired with a wine-tasting, as Colonial Williamsburg's acclaimed chef reviews his selections and discusses ways that even with today's busy lifestyles, there are relative easy ways to enhance the art of entertaining.

Special Children's Program with Lunch Sunday April 6, 2008 11:15 am – 1:30 pm

While NAHAD parents are busy, during the Annual Spouse Brunch and Members' Luncheon Program, NAHAD staff and Colonial Williamsburg staff will entertain your children (ages 3 and up) with a luncheon program and historic area tour geared towards children. The program will begin with a child-designed luncheon, located in a function room just down the hall from the Spouse Brunch. After lunch, the children will enjoy a special tour of the Historic Area (see page 17 for more information).

Manufacturer and Associate Contact Table Program Tuesday, April 8, 2008 8:30 am – 1:30 pm

Once again, this year's Contact Table Program has been lengthened to five hours! We have had many requests, both from Distributors – who would like additional time to visit all the Contact Tables and from Exhibitors – who have told us that they did not have ample time to speak with all attendees. We will include a strolling luncheon, with food stations scattered throughout the 140 exhibit tables manned by NAHAD's Manufacturer and Associate member companies. Also, exhibitors will be able to include limited display of products (see item 8 of Contact Table rules on page 14). As is our custom, Distributors will have the unique opportunity to meet one to one with Manufacturer and Associate suppliers who provide a variety of products, services, and programs of unique value to all members.

PAGE TRIMMED ON DIAGONAL

Program Highlights

All attendees will receive complimentary tote bags and 24th Annual Meeting collector's mugs. Preceding the program, there will be a separate breakfast buffet for exhibitors. Breakfast for non-exhibiting attendees will be held in the Virginia Foyer. Beverages will be provided throughout the program.

Manufacturer and Associate members are invited to register as soon as possible for an exhibit booth by completing the registration form on page 14. Booth selection will be on a first received, best selection basis. For further details, contact Lauren or Janice at the NAHAD office directly.

Colonial Tavern Dinners Tuesday, April 8, 2008

New in 2008! For those planning to stay in Williamsburg on Tuesday night, you will have one additional networking opportunity. Got a plane to catch first thing in the morning? Sign up for the early seating with a cocktail reception beginning at 5:00 pm. Colonial guides will escort you with fife and drums for dinner by candlelight at Shields

Tavern. If you can sleep in a bit later on Wednesday, sign up for the second seating. Your cocktail reception starts at 6:45 pm. Cap off your evening with after dinner coffee or a cordial from the bar back at the Williamsburg Lodge – on the lawn, if weather permits. A true colonial evening to round out this unique experience in Williamsburg. The cocktail reception and tavern dinner is included in your registration fee, but you must indicate which seating you prefer on the Registration Form on page 12.



PAGE TRIMMED ON DIAGONAL

Speakers & Presentations

Build it
Bigger – Extreme
Engineering

**Danny Forster –
Discovery Channel Host**

Sometimes, when Danny Forster finds himself suspended hundreds of feet in the air or wedged beside a stone crusher a hundred feet below ground, he wonders why he hadn't focused more on his schoolwork.



Of course, as the host of *Extreme Engineering*, it is Danny's great honor to give Discovery Channel viewers a closer look at some of the world's largest engineering projects — from the Arizona Cardinals stadium to the tallest building in Madrid. Given his morbid fear of heights and his healthy suspicion of giant stone crushers, though, it's just not always his great pleasure. If his attention hadn't wandered from his master's thesis in architecture to an ad on Craigslist.com, he'd probably be working in a firm right now, safely ensconced in — rather than on — a skyscraper somewhere. But, Danny often takes the road less traveled.

Like, perhaps, the road they're building under Kuala Lumpur, an enormous winding tunnel that doubles as a flood drain. That's one of the amazing places Danny has explored as host of *Extreme Engineering*, including construction sites in South Korea, New Orleans, Russia, Spain and a working aircraft carrier in an undisclosed location in California. At each job site, Danny gets his bearings and gives the audience a behind-the-scenes perspective. He helps out, kids around, and asks anyone he can about the big ideas and the tiny details that comprise some of the most incredible building projects ever attempted.

Between barely believable adventures with the Discovery Channel, Danny finally did complete his degree in architecture at the Harvard University Graduate School of Design. When he's not battling his fear of heights or bantering with welders twice his weight, he is a practicing architect in Boston, MA.



Strategic Sweet Spots for Market Success
Bill McCleave – W.R. McCleave & Associates

Recognized as a leading expert in Distribution Management and integrated supply, Dr. Bill McCleave specializes in relationship management. He was instrumental in the development of the widely adopted text, *MRO Supply Chain Management Guidebook*.

Unprecedented changes in distribution marketplaces have created both vast opportunities and confusion among many channel members. Based on seventeen years of research and consulting in the Distribution industry, Dr. McCleave provides no-nonsense answers to the big questions channel members are asking about the future. He combines his years of research and writing about the distribution industry into this high-impact presentation directed toward channel leaders who want to take control of their future through improving their market position. Bill will share new, valuable insights gleaned from recent NAHAD primary research, challenging attendees to take advantage of key information that is available in our businesses today to meet the challenges and opportunities that lie ahead. Highlights of the program will include: the future impact on size and value content on Distributors; which types of distributors will manufacturers turn to in the future?; the importance of service content now and in the future; and, the "value add" myth and the strategic sweet spot for distributors.

Ultimate Performance – Lessons in Extreme Leadership



Gary Jobson – Jobson Sailing

Gary Jobson, world class competitor, ESPN television commentator and prolific author is renowned as one of the foremost champions in the world of sailing and extreme yachting, having won many championships in one-design yachts, including the 1977 America's Cup with Ted Turner, the infamous Fastnet Race and many of the world's major ocean races. As a college All American sailor three times, Gary was twice named College Sailor of the Year. In 1999 he won the Nathanael G. Herreshoff Trophy, US Sailing's most prestigious award, and in 2003 was inducted into the America's Cup Hall of Fame. Jobson has been ESPN's sailing commentator since 1985, having won an Emmy in 1988 for his coverage of yachting at the Olympic Games in South Korea.

In this special luncheon presentation, Gary Jobson will present dynamic video highlights of his life experiences as a successful competitive sailor, author and TV commentator and will preview the Beijing Olympics, the America's Cup Races - 1851 through Valencia, his observations on the 32nd Cup, and key ocean racing events, including the Volvo Ocean Race, Key West Race Week and Outward Bound.



Build Your Online Marketing Machine
Bob DeStefano – SVM E-Business Solutions

Bob DeStefano is president and cofounder of SVM E-Business Solutions, a leading online marketing agency focused on delivering measurable business results for manufacturers. For over ten years, Bob has helped business leaders define and implement successful online marketing strategies. In the early 1990's during the birth of the commercial Web, Bob served as a strategic planner for Dean Witter, Discover specializing in Internet and e-commerce strategy for the financial services industry. An experienced speaker, Bob led a series of online marketing seminars for Fleet Bank and other organizations. He addresses relevant e-business trends and offers powerful, practical guidance for leveraging e-marketing to increase competitive advantage.

This session will help you to learn more about the exciting new arena of Online Marketing. Your company's Website can be transformed into a powerful online marketing machine. A results-focused approach to online marketing can put your company's goals and objectives at the core of every campaign – whether it is search engine marketing, a customer-focused Website or email newsletter campaign. And, more than any other marketing channel, online marketing allows you to measure the results generated from for every dollar you invest.

Learn more about the building blocks of this innovative approach: Search Engine Marketing - Rank high on the major search engines and attract new customers to your Website; Website Creation - Build a Website your customers will love and transform it into a lead generation machine; Email Marketing - Nurture relationships with customers and prospects with an educational e-newsletter and Marketing Analytics - Measure the return on your online marketing investments. Whether you are a company owner, sales manager or financial manager, you will benefit from learning more about achieving big goals by utilizing technology.

Sustaining Growth through Distribution Excellence

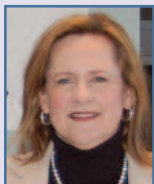

Kathy Newton – Purdue University

Dr. Kathy Newton is Professor of Industrial Distribution, and Head of the Department of Industrial Technology at Purdue University. She also serves as the Coordinator of NAHAD's University of Industrial Distribution, is widely published in academic and distribution trade journals and frequently works with distributors, manufacturers and trade associations nationally and internationally.

Success in today's marketplace requires a combination of: 1.) great planning, 2.) high-performance people, 3.) proactive, ongoing investments in training and development, and, 4.) great management of assets and technology. And, each of these must be aimed at being "wrapped around the customer." This session will help members to develop and implement successful strategies to address these critical impact factors, focusing on the core issues of managing product, people and performance.



Building a Value-Added Sales Culture

Tom Reilly – Tom Reilly Training

Celebrating his 25th year as a professional speaker, Tom Reilly is president of Tom Reilly Training, specializing in training salespeople and sales managers. Prior to beginning his full-time speaking and sales training career, Tom owned and operated a chemical company in Houston, Texas. His motto is simple: *Add Value . . . Not Cost. Sell Value . . . Not Price!*® Tom has a master's degree in psychology but quickly adds that he is a "salesman" first and foremost. He bills himself as a "how-to," "hands-on" type of trainer.

A few organizations compete at the top of their industries—*Value Added Peak Competitors*. They march to a different drum beat. These resource-disciplined, customer-focused organizations pursue excellence in all they do. Their respect for employees and customers make them a great place to work and shop. This session will help you to focus on: Understanding your organization's culture; Committing to the value-added philosophy; Communicating your message internally; Becoming customer-focused; Teaching employees to become profit centers;

Creating the value added culture in your department; and, Promoting value added teamwork involving employees in the value added process while creating change that lasts.

Building Customer Loyalty through Service

Christine Corelli – Christine Corelli & Associates, Inc.



Christine Corelli is a Chicago-based speaker, seminar leader, and consultant specializing in sales, customer service, and managing change. For nearly twenty years she has helped major corporations and small businesses increase their sales, improve their competitive stance, improve management/ employee and customer relationships, and establish higher levels

of customer loyalty. Christine is the author of *Wake Up and Smell the Competition*, *The ART of Influencing Customers to BUY from YOU* and *Capture Your Competitors' Customers - And KEEP Them*.

The customer rules! It's an all too familiar mantra, yet it warrants repeating, as ultimately, the customer will decide to what extent your distribution business will succeed. Winning customers and obtaining their loyalty requires answering some hard questions: How are you perceived in your customers' eyes? Are you their Number One preferred provider? How do your people represent you? What service flaws exist in your organization that you don't know about? Do you strive to provide a flawless customer experience? Would you do business with YOU? Christine will present practical solutions that you can apply, immediately, to ensure your customers have a consistently outstanding customer experience, and keep coming back to YOU, and not to your competition.

NAHAD Networking Dinner

Featuring - The Capitol Steps



Join your fellow NAHAD members for a somber, dignified evening as we honor the historical and political relevance of Williamsburg – the staid and honorable birthplace (or, rather, the labor & delivery room) of the American political system. Better yet... let's have some fun!

25 years ago, the *Capitol Steps* began as a group of U.S. Senate staffers who set out to satirize the very people and places that employed them.

In the years that followed, many of the Steps ignored the conventional wisdom (*"Don't quit your day job!"*), and although not all of the current members of the Steps are former Capitol Hill staffers, taken together the performers have worked in a total of eighteen Congressional offices and represent 62 years of collective House and Senate staff experience. Since they began, the Capitol Steps have recorded 27 albums, including their latest, *Springtime for Liberals*. They've been featured on NBC, CBS, ABC, and PBS, and can be heard 4 times a year on National Public Radio stations nationwide during their *Politics Takes a Holiday* radio specials.



The Capitol Steps have performed for the last five U.S. Presidents. And so, NAHAD is delighted to welcome the Capitol Steps as an antidote to the unending and insufferable debates, sound-bites, sniping, name-calling and political posturing of the past 18 months.



PAGE TRIMMED ON DIAGONAL

Speakers & Presentations

PAGE TRIMMED ON DIAGONAL

Tours Sports Fun

This year's registration includes several recreational activities at no additional charge. Every registered attendee will receive a special conference pass that is good for the duration of the conference and includes access to the Colonial Williamsburg Historic Area trade sites and museums. With more than 500 restored and reconstructed buildings spread across 301 acres of land, and a staff of 3500 archaeologists, researchers, historians, and historical interpreters, Colonial Williamsburg truly is a different time and place.

Also, we invite attendees to participate at no charge in the Colonial Muster and Drill on Saturday, April 5 at 12:45 pm and we invite children to participate in the 18th Century Games for Children at 2:30 pm (complimentary sign up requested) – both events will be held on the Virginia Lawn at the Williamsburg Lodge, weather permitting.

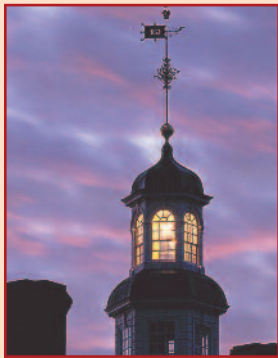

Evening Walking Tour
Friday, April 4, 2008
5:30 pm – 6:15 pm
Price: \$13 per person

A costumed interpreter will lead the NAHAD group through the Historic Area, giving a brief history of the Colonial Williamsburg Foundation and an overview of eighteenth century life in Virginia. This outdoor walking tour will provide an orientation for your visit to Colonial

Williamsburg and a nice opportunity to stretch your legs before you go to dinner on your own for the Friday night preceding the start of the convention.

NAHAD Round Robin Tennis Tournament
Saturday, April 5, 2008 **7:30 am – 10:30 am**
Price: \$45 per person

Enjoy a morning of tennis as NAHAD revives the classic Round Robin Tennis Tournament. Join the fun by signing up on page 12. We will need a minimum of 16 people to bring tennis back to NAHAD.



Orientation Walking Tour

I Saturday, April 5, 2008 **9:30 am – 10:30 am**

Price: \$11 per person

II Sunday, April 6, 2008 **9:30 am – 10:30 am**

Price: \$12 per person



An orientation walking tour led by an historical interpreter will give you a brief history of the Colonial Williamsburg Foundation, an introduction to eighteenth-century life in Virginia and advice on how to get the most out of your visit to the extraordinary museum city. *You will need to pick up your conference pass before you start your tour.*

Eighteenth Century Games for Children

Saturday, April 5, 2008
2:30 pm – 4:00 pm
Price: No Charge, but registration required



Learn about the leisure activities of children in the 18th century. Games were not only recreational, but were used for educating the young, teaching values, hand-eye coordination and history. A variety of games will be available for ages four to sixteen.

Afternoon Tea at the Williamsburg Inn

Saturday,
April 5, 2008
3:00 pm – 4:30 pm
Price: \$30 per person



Brighten your afternoon with an elegant tea hosted by a genteel lady portraying an eighteenth century resident of

Williamsburg. A variety of teas, scones and other treats will be served in the charming setting of the historic Williamsburg Inn.

Tenth Annual Fun Run/Walk

Sunday, April 6, 2008 **7:30 am – 8:30 am**

Price: \$15 per person, includes a 2008 NAHAD tee shirt

Take it fast or enjoy it slow, a bucolic Sunday morning activity and a tee shirt.

Delegate Golf Clinic

Sunday, April 6, 2008 8:30 am – 10:30 am

Price: \$40 per person, includes instruction and use of rental clubs, if needed.

Sharpen up your golf game before the annual NAHAD tournament or learn some basic skills to enjoy the game at your leisure. Seasoned instructors will provide an introduction to the fundamentals of the game that will assist participants of all skill levels with methods and techniques to improve their scores on the links. This clinic will include both full swing and short game. The clinic will be located at the Green Course, but you may board the shuttle from the Golden Horseshoe Clubhouse.

Golf and Refreshments for Ladies

Sunday, April 6, 2008 2:30 pm – 5:00 pm

Price: \$36 per person, includes instruction, use of rental clubs and light refreshments.

NAHAD's first lady, Leslie Lark, has designed this activity to be a fun-filled afternoon combining a golf clinic for beginners, with some social time for light refreshments and chatting. The activity will begin with instruction at the Golden Horseshoe Driving range. Golf clubs will be provided for those who did not travel with theirs. After an hour of instruction, you may want to continue on with a short nine-hole round on the Executive course. Play and payment will be on your own, as arranged by the NAHAD office. Or, you may want to retire to the Williamsburg Inn where light refreshments will be served. Either way, it will be a leisurely afternoon.

Williamsburg Winery Luncheon, Tour and Tasting

Monday, April 7, 2008 12:30 pm – 3:30 pm

Price: \$54 per person, includes transportation, luncheon, tour and tasting



Williamsburg Winery is Virginia's largest winery with an annual production of some 60,000 cases. With approximately 100 wineries in Virginia, the Williamsburg Winery accounts for almost one-quarter of all wine production in Virginia. The 50+ acres of vineyards which surround the winery offer a beautiful backdrop to the Old World-style village where the winery is located. Most of the wines have historical references listed on the back of each bottle. For example, Governor's White was named after Governor Berkeley, Virginia's first governor. Enjoy a buffet luncheon in Wessex Hall accompanied by a glass of wine, of course, and then you will be off for a guided tour and tasting session.



Jamestown

Settlement

Guided Tour

Monday, April 7, 2008

12:30 pm – 4:30 pm

Price: \$35, includes transportation, entrance fee and guided tour

In 1607, 13 years before the Pilgrims landed in Massachusetts, a group of 104

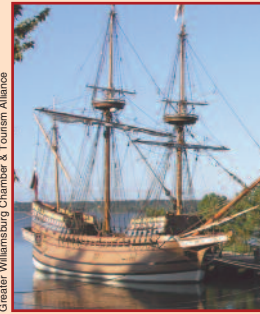

Greater Williamsburg Chamber & Tourism Alliance

English men and boys began a settlement on the banks of Virginia's James River. They were sponsored by the Virginia Company of London, whose stockholders hoped to make a profit from the resources of the New World. The community suffered terrible hardships in its early years, but managed to endure, earning the distinction of being America's first permanent English colony. Today at

Jamestown Settlement, the story of the people who founded Jamestown and of the Virginia Indians they encountered is told through film, gallery exhibits and living history. Outdoors, visitors can board replicas of the three ships that sailed from England to Virginia in 1607, explore life-size re-creations of the colonists' fort and a Powhatan village, and tour a riverfront discovery area to learn about European, Powhatan and African economic activities associated with water. In the outdoor areas, costumed historical interpreters describe and demonstrate daily life in the early 17th century. *You may purchase lunch or snacks from the Jamestown Settlement Café before the guided tour begins at 1:30 pm.*

NAHAD's Annual Golf Tournament

Monday, April 7, 2008

12:30 pm for a 1:00 pm Musket Start

Gold Course Price: \$185 • Green Course Price: \$145

Prices include greens fees, cart, box lunch, beverage, prizes and tournament services



Greater Williamsburg Chamber & Tourism Alliance

Golden Horseshoe Golf Courses, Williamsburg, VA.

Both courses are within one mile of each other on the property of the Resorts of the Colonial Williamsburg.

NAHAD will provide shuttle service between the Lodge, Inn, Providence Hall and Woodlands and the courses. The courses have been highly rated by *Golf Digest*, please select your course of play based upon your ability and budget.

The Gold Course – Opened in 1963 and the work of Robert Trent Jones Sr., who called it his “finest design,” this is one of the best examples of traditional golf course architecture in the world. With tight fairways, plenty of mature trees and water features, this course will challenge you to bring your “A” game.



PAGE TRIMMED ON DIAGONAL

Tours Sports Fun

PAGE TRIMMED ON DIAGONAL

Tours Sports Fun

The Green Course -

Designed by Rees Jones, Jones Sr.'s son, and opened in 1991, this layout is carved from the same terrain but is simultaneously longer and more forgiving. Recommended for the social golfer who only plays a few times each year.

With separate pricing and scoring, NAHAD will host two complete tournaments, both with a colonial musket start and scramble format. This year, NAHAD will offer a modified Captain's Choice format which should produce more competitive play and several prizes, including Hole-in-One cash prize of \$10,000 on both courses should add to the excitement. Please indicate on the Registration Form if you would like to be paired with another member – you are encouraged to contact potential partners in advance to select the same course. Pairings will be done on a first noted, first designated basis.

Yorktown Victory Center Guided Tour

Monday, April 7, 2008 1:30 pm – 4:30 pm

Price: \$32, includes transportation, entrance fee and guided tour

On October 19, 1781, the decisive military campaign of the American Revolution culminated with the British surrender to combined American and French forces under the command of George Washington. The Siege of Yorktown effectively ended the six-year struggle for American independence and set the stage for a new government and nation. Today at the Yorktown Victory Center, America's evolution from colonial status to nationhood is chronicled through a unique blend of timeline, film, thematic exhibits and outdoor living history. An outdoor exhibit walkway details events that led to American colonies to declare independence from Britain. *Snacks and drinks may be purchased from vending machines, but there is no facility for lunch; so please eat lunch before departing on this tour.*

Work and Enterprise in Colonial Williamsburg

I Monday, April 7, 2008 1:30 pm – 3:30 pm

Price: \$21 per person

II Tuesday, April 8, 2008 2:00 pm – 4:00 pm

Price: \$22 per person

Designed to give you a glimpse into the working world of the 18th century, this walking tour will focus on the trades practiced in this colonial city. A glimpse into the tools and skills needed by coopers, printers and binders, blacksmiths, brickmaker, saddler, carpenters, cabinetmakers, wheelwrights, founders, and gunsmiths may be featured. As you explore this world on foot, led by a knowledgeable interpreter, keep in mind the work needed to restore and recreate Colonial Williamsburg. In a century



when most structures were built from wood, no tradesman was more useful than the carpenter. The main business of the colonial carpenter was to cut and join timber and board into sturdy wooden homes and shops. As Williamsburg blossomed, the demand for new homes, shops, outbuildings stables, sheds, and their repair grew at a rapid pace.



Ghost Tavern Tour
Monday, April 7, 2008
8:00 pm – 9:00 pm
Price: \$14 per person

Join your fellow NAHAD members on a special walking tour led by a costumed interpreter using a lantern to light your way. Do the ghosts of the past live on in the taverns, homes and streets of Williamsburg? You can be the judge of that.

Spouse Plantation Tours and Luncheon
Tuesday, April 8, 2008 9:00 am – 3:30 pm
Price: \$93 per person, includes admission to two plantations, luncheon, guides and motorcoach transportation

Start your day with a tour of Berkeley Plantation. Said to be the most historic of the James River Plantations, Berkeley is the birthplace of a signer of the Declaration of Independence and a U.S. President. On December 4, 1619, early settlers from England came ashore at Berkeley on the Good Ship Margaret and observed the first official Thanksgiving in America. Benjamin Harrison, son of the builder of Berkeley and the plantation's second owner, was a signer of the Declaration of Independence and three-time Governor of Virginia. William Henry Harrison, Benjamin's



Greater Williamsburg Chamber & Tourism Alliance

third son, born at Berkeley, was the famous Indian fighter who later became the ninth President of the United States in 1841. His grandson, Benjamin Harrison, was the 23rd President.



Greater Williamsburg Chamber & Tourism Alliance

Next, you will travel to Charles City Tavern where a delicious three-course lunch will set you back on the road to visit a second plantation – Shirley Plantation. Shirley is the oldest plantation in Virginia and the oldest family owned business in North America.

Founded six years after the settlers arrived in Jamestown, the present mansion was begun in 1723 when Elizabeth Hill, great-granddaughter of the first Hill, married John Carter, eldest son of Robert "King" Carter. It was completed in 1738 and is largely in its original state. The home is recognized as an architectural treasure. A guided tour of the main floor reveals original 18th-century hand-carved woodwork, family portraits, silver, furniture and other decorative pieces. A 3 1/2 foot wooden pineapple, gracing the Mansard roof, has signified hospitality for almost 250 years. There will also be some shopping opportunities in gift shops during your day of Plantation tours.



NAHAD Twenty Fourth Annual Meeting & Convention

Colonial Williamsburg * Williamsburg, VA * April 5 - 9, 2008 Page 1 of 2

Please Check One: Distributor Manufacturer Associate Affiliate

Please check if first time attendee: First Time Attendee

Please type or print information, as you would like it to appear on your Registration Badge and in the Official Convention Program. Please submit one copy of this form, or a photocopy for each individual or family attending NAHAD's Twenty Fourth Annual Meeting & Convention.

Payment must accompany your registration. To register by fax, sign this registration form, indicating your VISA, MasterCard, Discover or American Express number and the expiration date. Or, mail a copy of the completed form with your check to: NAHAD, 105 Eastern Avenue, Suite 104, Annapolis, MD 21403-3300. Delegate registration forms received by February 8, 2008 will be included in the official convention program, and will qualify for the \$545 early registration fee. The \$595 regular registration fee will apply to delegate registrations received between February 9, 2008 and March 5, 2008. Delegate registrations received after March 5, 2008 will pay the \$650 late-faxed-in delegate registration fee.

Delegate Name _____ Badge Nickname _____

Title _____

Company Name _____

Company Address _____

City _____ State/Province _____ Zip/Postal Code _____

Country _____ Email _____

Phone _____ Fax _____

Do you have any physical conditions requiring special needs? Yes No

If yes, please specify _____

Do you have any dietary restrictions? Yes No

If yes, please list _____

Spouse/Guest Name (if attending) _____ Badge Nickname _____

Child Name #1 _____ Badge Name _____ Age _____

Child Name #2 _____ Badge Name _____ Age _____

Child Name #3 _____ Badge Name _____ Age _____

My Child(ren) will be participating in the NAHAD sponsored Colonial Williamsburg activities.

Please send a Children Sign Up sheet to the following address:

Home Address (spouse/guest correspondence will be mailed to the home)

Address _____

City _____ State/Province _____ Zip/Postal Code _____

Country _____ Email _____

Do you have any physical conditions requiring special needs? Yes No

If yes, please specify _____

Do you have any dietary restrictions? Yes No If yes, please list _____

Pre-planning Information Please check one selection for April 7, 2008.

Delegate: I plan to attend:

- Early Tavern Dinner (5:45 pm) April 8, 2008
- Late Tavern Dinner (7:45 pm) April 8, 2008
- I will be traveling home on April 8 and unable to attend either tavern dinner

Meeting
Registration

Registration and Cancellation Policies

In order to obtain a refund for convention registration fees or golf, written notice of cancellation is required, to be received at the NAHAD office, by the dates noted below:

By February 8, 2008 –
for Full Refund

By March 5, 2008 –
for 50% Refund

After March 5, 2008 -
No Refund

Tour Cancellation Policy

All tours are subject to cancellation if minimum enrollments are not met. Registrants will receive notification, if possible, and full refund if tour is cancelled by NAHAD. Refunds will be issued by May 31, 2008.

If a member wishes to cancel a tour registration, written notification must be received by the NAHAD office no later than February 8, 2008, for full refund. No Tour Refunds will be issued for cancellation requests received after March 5, 2008.

Mail all Meeting Registrations and payment (not Hotel reservations) to:

NAHAD
105 Eastern Avenue
Suite 104
Annapolis, MD
21403-3300.

Make all checks payable to NAHAD.

Register online at
www.nahad.org



Registration Fees/Optional Tours and Activities Sign Up Page 2 of 2

Delegate Name	Cost USD	Delegate	Spouse/Guest Companion	Child 1	Child 2	Child 3
Delegate Early Registration Fee <i>(If paid by February 8, 2008)</i>	\$545		<input type="checkbox"/>	<input type="checkbox"/>	<input type="checkbox"/>	<input type="checkbox"/>
Delegate Regular Registration Fee <i>(If paid between February 9, 2008 & March 5, 2008)</i>	\$595		<input type="checkbox"/>	<input type="checkbox"/>	<input type="checkbox"/>	<input type="checkbox"/>
Delegate Late-Fax-In Registration Fee <i>(If paid after March 5, 2008)</i>	\$650		<input type="checkbox"/>	<input type="checkbox"/>	<input type="checkbox"/>	<input type="checkbox"/>
Spouse/Guest/Companion Registration Fee	\$295	<input type="checkbox"/>		<input type="checkbox"/>	<input type="checkbox"/>	<input type="checkbox"/>
Golf Tournament at Gold Course <i>Monday, April 7, 1:00 pm</i>	\$185			<input type="checkbox"/>	<input type="checkbox"/>	<input type="checkbox"/>
OR Golf Tournament at Green Course <i>Monday, April 7, 1:00 pm</i>	\$145			<input type="checkbox"/>	<input type="checkbox"/>	<input type="checkbox"/>
Delegate: Golf Club Rental (Callaway) Indicate <input type="checkbox"/> Left <input type="checkbox"/> Right <i>Indicate Handicap/Avg. Score _____ / _____ I'd like to play with _____</i>	\$55		<input type="checkbox"/>	<input type="checkbox"/>	<input type="checkbox"/>	<input type="checkbox"/>
Spouse/Guest/Companion: Golf Club Rental (Callaway) Indicate <input type="checkbox"/> Left <input type="checkbox"/> Right <i>Indicate Handicap/Avg. Score _____ / _____ I'd like to play with _____</i>	\$55	<input type="checkbox"/>		<input type="checkbox"/>	<input type="checkbox"/>	<input type="checkbox"/>
Evening Walking Tour <i>Friday, April 4 • 5:30 pm – 6:15 pm</i>	\$13					
Round Robin Tennis Tournament <i>Saturday, April 5 • 7:30 am - 10:30 am</i>	\$45			<input type="checkbox"/>	<input type="checkbox"/>	<input type="checkbox"/>
Orientation Walking Tour I <i>Saturday, April 5 • 9:30 am – 10:30 am</i>	\$11					
Eighteenth Century Games for Children <i>Saturday, April 5 • 2:30 pm – 4:00 pm</i>	N/C	<input type="checkbox"/>	<input type="checkbox"/>			
Afternoon Tea at the Williamsburg Inn <i>Saturday, April 5 • 3:00 pm – 4:30 pm</i>	\$30			<input type="checkbox"/>	<input type="checkbox"/>	<input type="checkbox"/>
Tenth Annual Fun Run Walk <i>Sunday, April 6 • 7:30 am – 8:30 am</i>	\$15					
Delegate Golf Clinic <i>Sunday, April 6 • 8:30 am – 10:30 am</i>	\$40			<input type="checkbox"/>	<input type="checkbox"/>	<input type="checkbox"/>
Orientation Walking Tour II <i>Sunday, April 6 • 9:30 am – 10:30 am</i>	\$12					
Golf and Refreshments for Ladies <i>Sunday, April 6 • 2:30 pm – 5:00 pm</i>	\$36	<input type="checkbox"/>		<input type="checkbox"/>	<input type="checkbox"/>	<input type="checkbox"/>
Williamsburg Winery, Lunch and Tasting <i>Monday, April 7 • 12:30 pm – 3:30 pm</i>	\$54			<input type="checkbox"/>	<input type="checkbox"/>	<input type="checkbox"/>
Jamestown Settlement Guided Tour <i>Monday, April 7 • 12:30 pm – 4:30 pm</i>	\$35					
Yorktown Victory Center Guided Tour <i>Monday, April 7 • 1:30 pm – 4:30 pm</i>	\$32					
Work & Enterprise in Colonial Williamsburg I <i>Monday, April 7 • 1:30 pm – 3:30 pm</i>	\$21					
Ghost Tavern Tour <i>Monday, April 7 • 8:00 pm – 9:00 pm</i>	\$14					
Spouse Plantation Tours & Lunch <i>Tuesday, April 8 • 9:00 am – 3:30 pm</i>	\$93	<input type="checkbox"/>		<input type="checkbox"/>	<input type="checkbox"/>	<input type="checkbox"/>
Work & Enterprise in Colonial Williamsburg II <i>Tuesday, April 8 • 2:00 pm – 4:00 pm</i>	\$22					
Total Fees Due for Each Attendee:	USD	\$	\$	\$	\$	\$

GRAND TOTAL DUE: USD \$

Payment Options

Enclosed is my check for \$ _____

Please make checks payable in U.S. dollars, to **NAHAD**, and mail to: **NAHAD, 105 Eastern Avenue, Suite 104, Annapolis, MD 21403-3300.**

Please charge to my (check one) VISA MasterCard Discover American Express

Account # _____ Exp. Date _____ Verification Code _____

Name on Card *(please type or print)* _____ Card Signature _____



Telephone Inquiries (800) 624-2227 Register by Fax (410) 263-1659 Register online at www.nahad.org

FOR OFFICE USE ONLY

Check Date _____ Check Number _____ Invoice Number _____

Williamsburg Lodge

Upper Level

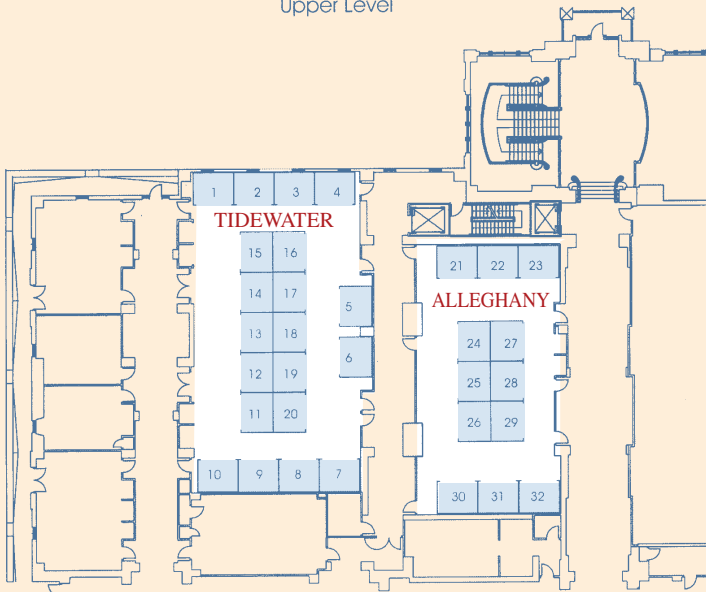

All Booths 10 ft. Wide x 8 ft. Deep

Williamsburg Lodge

Lower Level

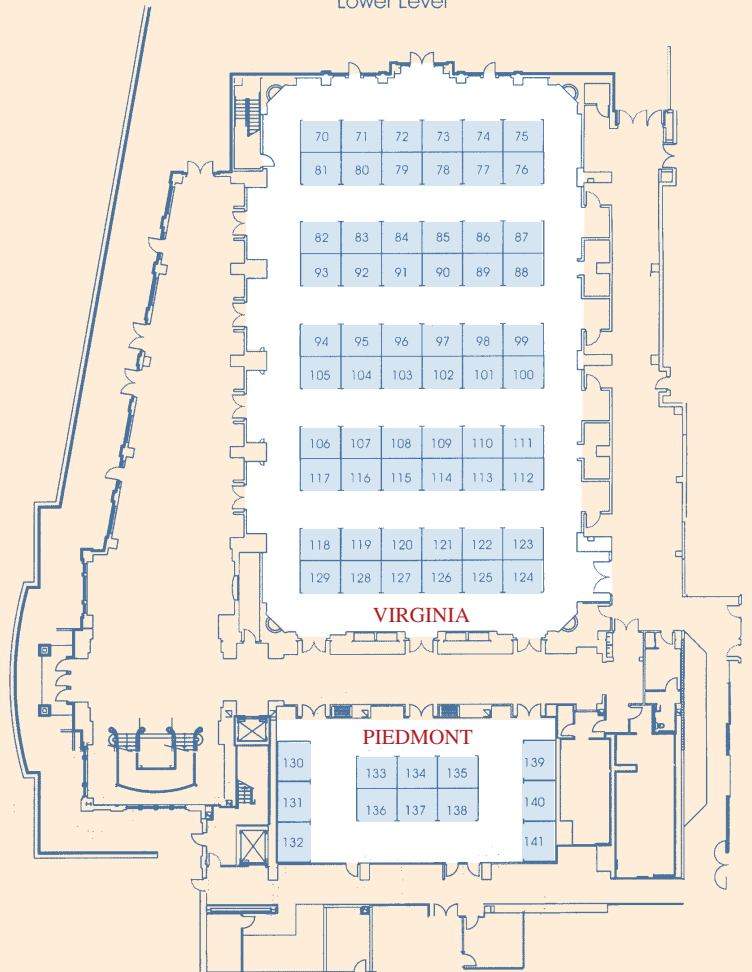

All Booths 10 ft. Wide x 8 ft. Deep

Area and Hotel Information

Williamsburg was the thriving capital of Virginia when the dream of American freedom and independence was taking shape and the colony was a rich and powerful land stretching west to the Mississippi River and north to the Great Lakes. For 81 formative years, from 1699 to 1780, Williamsburg was the political, cultural, and educational center of what was then the largest, most populous, and most influential of the American colonies. It was here that the fundamental concepts of the early republic — responsible leadership, a sense of public service, self-government, and individual liberty — were nurtured under the leadership of patriots such as George Washington, Thomas Jefferson, George Mason, and Peyton Randolph.

Today, the Colonial Williamsburg Experience offers 301 acres of the largest interactive living history museum in the United States. With 88 original buildings and 500 reconstructed colonial homes, government buildings, trade shops and taverns, day time programs bring the visitor into the life in the 18th century. **Registration for this year's meeting comes with a full-stay pass, so that you can visit the exhibit buildings and museums on your own timetable during the open time built into the schedule.**

In many ways, Colonial Williamsburg resembles a college campus with lodging opportunities, recreation facilities, spa, shops and eating establishments situated throughout the campus. For lodging, the largest property is the 323 guest room Williamsburg Lodge, with 62 rooms in the historic Williamsburg Inn, 43 rooms in the Providence Hall Guesthouses, the Williamsburg Woodlands and 26 authentic Colonial Houses which range in size from one sleeping room to 16 sleeping rooms. Most association functions will be held in the Lodge; however, there will be smaller meetings, including Hospitalities on Hospitality Suite night, held in the Williamsburg Inn and surrounding buildings.

The **Williamsburg Lodge**, after an extensive two-year building, remodeling, and refurbishing project completed in early 2007, now comprises eight



buildings interconnected by sheltered brick-paved walkways. One of the two original hotels envisioned by John D. Rockefeller Jr. for Colonial Williamsburg, the Williamsburg Lodge offers 323 attractively appointed guest rooms and suites with modern amenities, including wireless internet access in all rooms. The Conference

Center is located within the complex of the Williamsburg Lodge making this location the most direct access to the meetings facilities.

Following a year-long renovation, the **Williamsburg Inn** reopened to the public in late 2001. The careful renovation of the Inn encompassed every aspect of its interior - the original furniture designed specially for this famous hotel has been refinished and reupholstered, chandeliers brilliantly refurbished, a new tearoom and bar lounge have been



incorporated into the first floor, along with modest alterations to the Regency Dining Room. Guestrooms have been significantly enlarged to include elaborate baths. The famous facade of the Williamsburg Inn hotel has not changed as inside the renovations span three centuries of style: 19th-century Regency decor, the 20th-century heritage of the original building, and 21st-century amenities. It surely reflects what Rockefeller envisioned: a historic country inn with the most modern, gracious appointments and offers 62 rooms and suites in the main building.



Colonial Houses are ideal for guests who wish to fully immerse themselves in the 18th century; Colonial Williamsburg offers authentic period accommodations in the Historic Area where our founding families once lodged. The Colonial Houses offer accommodations

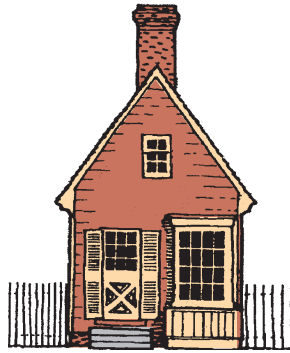

in colonial style at 26 guest houses, some as small as one room within a tavern and others as large as 16 rooms. Furnished with authentic period reproductions and antiques, each Colonial House has a unique history and appeal of its own, offering a rare way to experience the restored 18th-century capital of Virginia. Registration and check-in for Colonial Houses is at 305 South England Street, across from the Williamsburg Lodge and adjacent to the Williamsburg Inn. Please refer to the property map to verify the location of the home and its proximity to the Williamsburg Lodge.

Providence Hall Guesthouses - located just a few steps from the main Williamsburg Inn building—are for visitors who seek serene privacy and want the resort pleasures of the Williamsburg Inn, tennis courts, and a superb golf course just outside their door. A forested area with pond and waterfowl creates a natural screen that invites visitors to enjoy the breezes and the view from their patio or balcony. Spacious guest rooms appointed



with king-size beds and queen-size sleep sofas feature an interior decor that blends contemporary design with oriental accents. With tennis, golf, and the Historic Area no more than a stroll away, it's no wonder many businesses take advantage of the Providence Hall

Guesthouses for executive retreats. Yet the versatility, space, and location of the Providence Hall Guesthouses make them equally appealing to families. Registration and check-in for Providence Hall is at 305 South England Street, across from the Williamsburg Lodge and adjacent to the Williamsburg Inn.

Nestled on the edge of a 40-acre pine forest, this moderately priced Williamsburg hotel is a family haven. **The Williamsburg Woodlands** is



right at the starting point of the 18th century, at the Visitor Center for Colonial Williamsburg. This facility offers the most inexpensive option for convention housing, but it requires a 15 minute walk via the Walking Trail to the Historic Area or a brief ride on a shuttle bus which circles the Historic

area, with a stop at the Williamsburg Lodge at regular intervals. Pricing includes a Continental breakfast and the property has its own recreational facilities, providing an economical choice for families. For business travelers, the property includes complimentary high speed internet access and dual data ports.



← TO RICHMOND ROAD U.S. ROUTE 60

BYPASS ROAD

Colonial Williamsburg®

HISTORIC AREA



Williamsburg Woodlands Conference Center
Cascades Motel
Williamsburg Woodlands Hotel & Suites
Huzzah! Restaurant
Visitor Center
Group Arrivals
Parking
Great Hopes Plantation

4

Governor's Inn
Amtrak & Bus Depot
U.S. Post Office

LAFAYETTE STREET
POLICE DEPARTMENT
SCOTLAND STREET
BOUNDARY STREET
NORTH PRINCE STREET
MERCHANTS SQUARE
FRANCIS STREET
NEWPORT AVENUE

VA. ROUTES 5, 31, 162
Palace Shuttle Stop
Governor's Palace
Kitchen
Gateway Information
Wheelwright
Robert Carter House
McKenzie's Store
Everard House
Play Booth Theater
Tucker House
Wythe House, Weaver & Basketmaker
Bruton Parish Church
Mary Dickinson Store
Greenhow House
Colonial Garden & Nursery
African American Religion Exhibit
Public Hospital of 1773
Museum Parking
Employee Parking

VA. ROUTES 5, 31, 162
Red Line 9 a.m. to 5 p.m.
Windmill
Carpenter
Brickyard
Cabinetmaker
Geddy House & Foundry
Chowning's Tavern
Courthouse
Cooper
Prentis Store
Printing Office, Bindery & Post Office
M. Dubois Grocer
Mary Stith House
Blacksmith Shop
Williamsburg Lodge
Williamsburg Inn
The Spa of Colonial Williamsburg
Golden Horseshoe Gold Clubhouse Grill & Pro Shop
Golden Horseshoe Green Clubhouse Grill & Pro Shop

1 2

NEWPORT AVENUE

NAHAD Key

KEY

	Historic Points of Interest and Museums		Automated Teller Machine
	Food and Dining		Phone
	Shopping		Restrooms
	Colonial Williamsburg Hotels		Accessible Restroom
	Footbridge and Path		Accessible Family Restroom
	Information and Tickets		Blue Line Shuttle Route & Stops (Circles Historic Area 9 a.m.–10 p.m. Includes Visitor Center 5–10 p.m.)
	Refreshments and Recycling		Red Line Shuttle Route & Stop (Visitor Center to Palace stop 9 a.m.–5 p.m. only)
	Water Fountains		

0 1/8 1/4 Mile

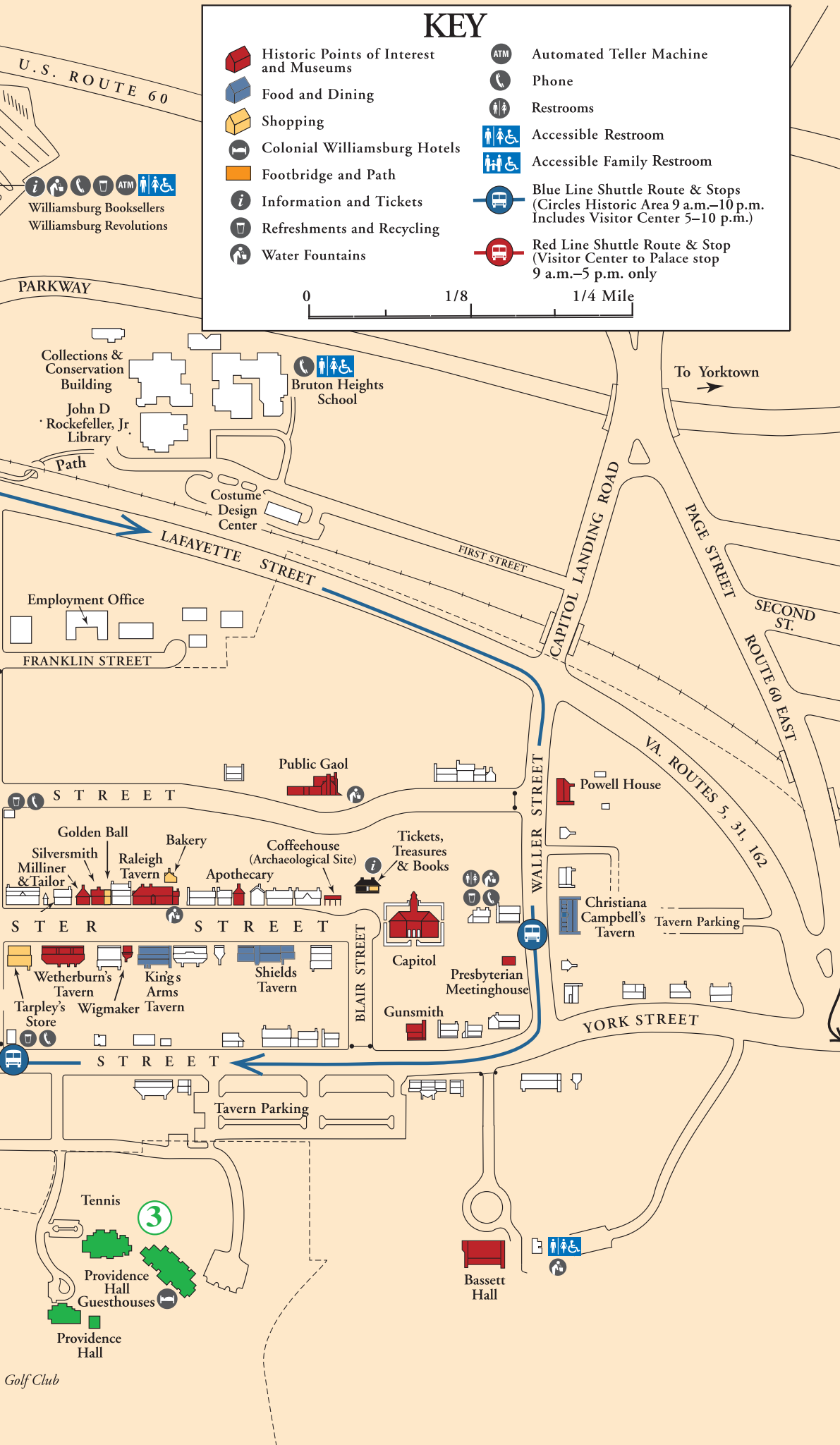

1 Williamsburg Lodge



2 Williamsburg Inn



3 Providence Hall Guest Houses



4 Williamsburg Woodlands Hotel & Suites



Colonial Williamsburg

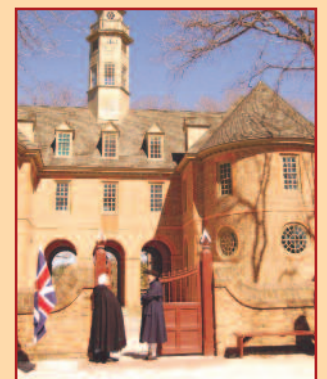

Transportation

Traveling by car, Colonial Williamsburg is midway between Richmond and Norfolk on I-64 (exit 238). After exiting, look for the America's Historic Triangle directional signs (blue with red-and-white "ribbon"), where you'll notice the Colonial Williamsburg logo.

For Map Quest and GPS purposes, please use the following addresses:

- **Williamsburg Inn** 136 East Francis Street, Williamsburg, VA 23185
- **Williamsburg Lodge** 310 South England Street, Williamsburg, VA 23185
- **Woodlands Hotel and Suites** 105 Visitor Center Drive, Williamsburg, VA 23185

Registration and check-in for Colonial Houses and the Providence Hall Wings is at 305 South England Street, across from the Williamsburg Lodge and adjacent to the Williamsburg Inn. Driving time is approximately 2 1/2 hours from Washington, DC.

By air, there are three airports that you may wish to choose: Newport News-Williamsburg, Norfolk and Richmond. Your choice of airport will depend on your air carrier choice and ease of access from your departure city. Each has rental car and limousine services.

Norfolk (www.norfolkairport.com) ORF is serviced by seven major airlines:

- **American/American Eagle** (800) 433-7300
- **Continental/Continental Express** (800) 525-0280
- **Delta/Delta Connection** (800) 221-1212
- **Northwest/Northwest Airlink** (800) 225-2525
- **Southwest** (800) 435-9792
- **United Express** (800) 241-6522
- **US Airways/US Airways Express** (800) 428-4322

Ground Transportation from Norfolk: there is shuttle service through Carey VIP Airport Connection (757) 963-0433 or (866) 567-7213 (Toll-free). Taxi and rental cars are also available. Driving distance to Williamsburg is approximately 45 minutes.

Newport News-Williamsburg (www.nnwairport.com) PHF is serviced by Air Tran, Delta and US Airways Express. It is the closest airport to Williamsburg, with an estimated driving time of approximately 20 minutes; but it is only serviced by three air carriers. Ground shuttle service can be arranged through Carey VIP Airport Connection (757) 963-0433 or (866) 567-7213 (Toll-free). Taxi and rental cars are also available.

Richmond International Airport (www.flyrichmond.com)

RIC is serviced by 9 major airlines:

- **AirTran** (800) 247-8726
- **American/American Eagle** (800) 433-7300
- **Continental/Continental Express** (800) 525-0280
- **Delta/Delta Connection** (800) 221-1212
- **JetBlue Airways** (800) 538-2583
- **Northwest/Northwest Airlink** (800) 225-2525
- **Skybus** www.skybus.com
- **United** (800) 241-6522
- **US Airways/US Airways Express** (800) 428-4322

Ground shuttle transportation is provided by Groome Transportation (800) 552-7911, every hour on the hour with no reservation required. The cost of the service is \$40 per person one way and \$25 for each additional person. Taxi and rental cars are also available. Driving time to Williamsburg is approximately 50 minutes.



105 Eastern Avenue
Suite 104
Annapolis, MD 21403-3300

www.nahad.org

First Class
U.S. Postage
PAID
Permit No. 875
Annapolis, MD